



**युनाइटेड इंडिया इन्श्यूरेन्स कं. लि.**  
**UNITED INDIA INSURANCE CO. LTD.**

[A Government of India Enterprise]  
Registered & Head Office, United India House  
24, Whites Road, Chennai – 600 014

**TENDER FOR PROPOSED INTERIOR FURNISHING; ELECTRICAL AND  
RELATED WORK AT UIIC LTD, DIVISIONAL OFFICE-2, LIC BUILDING,  
PANDRI, RAIPUR (C.G.)**  
Volume - C  
[Financial Bid]

**Employer**

United India Insurance Co Ltd  
Head Office, United India House  
24, Whites Road  
Chennai – 600 014  
Ph: 044- 28 575 421/282/281

**Consultant**

M/s NICON INDIA  
Architects, Engineers, Planners  
34, Gurukul Complex, Kalibadi  
Road, Raipur (C.G.) 492001  
Ph: 98271-58700, 98263-23237

Interior Furnishing, Electrical and related works of  
United India Insurance Co. Ltd. Divisional Office-2, LIC Building, Pandri, Raipur



United India Insurance Co. Ltd.  
Regional Office, Raipur: 647A, 648, 649, 6th Floor, Magneto Offizo, Magneto The Mall,  
Labhandi, Raipur, C.G.

ABSTRACT OF SECTION III

ITEM	AMOUNT
PART – A	
1. Interiors and furnishing works	Rs.
2. False Ceiling works	Rs.
3. Painting works	Rs.
4. Electrical Works	Rs.
Total	Rs

In words

Place:

Seal & Signature

Date:

## SECTION - II

### TECHNICAL SPECIFICATION

#### A. Introduction to Technical Information Section

Various works are to be done for the interior work in the different Branches of United India Insurance Co. Ltd. by supplying / installing / fixing in position as per the approved plan / design and as per the details and specification under strict & successful implementation of all the terms, condition, limitations and binding laid down in the tender documents. The work includes fabrication of aluminum partition, furniture miscellaneous electrical works, painting work and flooring work.

The information, instructions and details provided here after are the technical know how of the work to be done, which shall be carefully read & understood before filling up the tender and shall be implemented exactly in the same fashion they mean.

Most of the information & instructions are repeated several times to make the things clear at every point.

#### LIST OF MATERIALS AND THEIR APPROVED MANUFACTURES

1. Block Board Marine Grade and plywood	Green/Triveni/Hans/Trueewood/Richwood Conforming to IS-3001 BWP Commercial grade
2. Particle Board	Eco Board, Nova pan
3. Laminates	Green/Formica/Sunmica
4. Locks	Godrej, Doorset, Link, Quba
5. Hardware	Earl Bihari/Dorma/Hatelle
6. Glazing	Asahi, Saint Gobain, Modifloat
7. Door Closers	EarlBihari,Hardwyn, Shakti, Hyper, Amar
8. Paints	Asian paint/ICI/Berger/Nerolac
9. Fire Retardants	Viper
10. Sanitary ware	Parryware, Neycer, Cera, Impolo, Tita
11. Tiles	Johnson, Kajaria, Nitco, Western Marbo
12. Plumbing fixtures	Marc, Jaguar, Roca, Plumber
13. Aluminium Sections	Oel, Jindal, RR
14. Blinds	Vista Levlor, Mac, Marvel, Track
15. Antistatic Floor	Asian/Armstrong
16. Ceiling	India Gypsum/Lafarge board
17. POP Beading/Cornice	India Gypsum/Diamond
18. Water Proofing Compound	SIKA,
19. Steel Section	TATA, SAIL, Jindal, Goel, Nirman
20. Adhesives	Fevicol, Vishwascol
21. Chairs	Godrej/ Wipro/Featherlite

## APPROVED MAKE OF MATERIALS

(For Electrical works)

S. No.	Description	Make
1	PVC insulated copper wires (Multi stranded 650 V Gr.)	L & T / RR Cable / Finolex / Havells, Polycab/Anchor
2	MS Conduit and accessories	BEC / NIC / AKG
3	Coaxial TV Cable	Finolex / National
4	Telephone wire	Finolex / Delton / Anchor/ Havells
5	Aluminum Armoured XLPE / PVC cables	Havells / Finolex / CCI / Gloucester
6	MCCB / MCB / ELCB / DB	Legrand / Seimens / L & T / Hagger / Schneider / Havells/ ABB
7	Load line DB	MDS / Havells, L&T/ ABB/ Legrand
8	Ceiling fans	Crompton / Usha / Havells
9	Exhaust fan	Crompton / Havell's / GEC
10	Luminaries LED	Philips /Crompton / Wipro / Havells/Halonix
11	Decorative light fittings	Philips /Crompton / Wipro / Havells / Decon/ Halonix
12	PVC non metallic conduits and accessories	BEC / Precision / AKG, Polycab
13	Panel Manufacturer	CPRI approved manufacturers.
14	Bulb holders, Ceiling rose, 6/16 A Switch socket /Telephone socket / TV Outlet / Fan regulators.	Anchor Roma/ Legrand / Havells/Crab tree
15	G I Pipes	Swastik / Khandelwal / Prakesh
16	Lugs / Glands	Dowells / Comet/ L&T
17	Data Cable (Cat 6e)	D- Link

Note:

All the materials to be of ISI make.

The contractor shall submit sample of the above approved material and the Consultant/ Client shall have the discretion to approve any of them.

Consultant / Client decision in this regard shall be final and binding.

In case any material is not available for any one or all the approved make the Consultant / Client shall select and approve alternative make.

INTERIOR FURNISHING ELECTRICAL & RELATED WORKS OF UIIC LTD.

DO-2, LIC BUILDING, PANDRI, RAIPUR (C.G.)

1. INTERIOR FURNISHING WORKS

S.No.	Item/Description	Qty	Unit	Rate Rs.	Amount Rs.
1	<p>Partition (Solid) or with glass</p> <p>a Sal wood frame of section 2.5"x1.5" fixed in position with 2.5" to 3" long steel neettle fold screw. The vertical and horizontal members being placed at 2' c/c as per site condition as directed.</p> <p>b Panel for solid partition fixing 6 mm water proof anti termite, borer proof plywood of True wood, Hans wood Triveni make on both the sides of frame work with fevicol SH and headless nails of 17 nos of 1.25" length and securing the cover with 1.5" long steel nettled fold screw. Making the plywood surface level before fixing the laminate/veneer.</p> <p>c 1 mm th laminate/ mica fixing on inside of panel with 1.2 mm th. Groove in the panel as per the design with provision of the openings in the panel for switch boards, box and cuts in frame for carrying conduits if necessary, and fixing 1.0 mm laminate on the outside face of shade and colour a per UIIC colour scheme given in the tender specification with glass to be given given in the design. The open edge are to be blocked by teak wood bead of required size and design.</p>	1280	sft		
2	<p>Glazed Partition in 10/12 mm glass with</p> <p>Sal wood frame of section 2.5"x1.5" fixed in position with 2.5" to 3" long steel neettle fold screw. The vertical and horizontal members being placed at 2' c/c as per site condition as directed.</p> <p>Panel for solid partition fixing 6 mm water proof anti termite, borer proof plywood of True wood, Hans wood Triveni make on both the sides of frame work with fevicol SH and headless nails of 17 nos of 1.25" length and securing the cover with 1.5" long steel nettled fold screw. Making the plywood surface level before fixing the laminate/veneer.</p> <p>1 mm th laminate/ mica fixing on inside of panel with 1.2 mm th. Groove in the panel as per the design</p>				

	with provision of the openings in the panel for switch boards, box and cuts in frame for carrying conduits if necessary, and fixing 1.0 mm laminate on the outside face of shade and colour as per the colour scheme given in the tender specification with glass to be given given in the design. The open edge are to be blocked by teak wood bead of required size and design.	360	sft		
3	Providing and fixing of door fixtures. a) Door handle mortise type Godrej, Door set make b) Door Stopper (Hyper, Amber, Shakti) c) Floor Machine (Hyper, Amber, Shakti, Hardwyn) d) Door closure (Hyper, Amber, Shakti, Hardwyn) e) SS handle 12" long (Door set, Amber, Shakti)	4 4 4 8 4	nos nos nos nos nos		
4	Wall paneling in column room full height in column and conference hall up to 9'3'6" height with 6 mm plyboard of Hanswood, True Wood, Triveni make with 1.0 mm th of colour and shade as given in tender specification.	350	sft		
5	Fabricating and fixing in position in DM/AM/Dev Mgr room table of size X'x 3' x 2'6" with drawers etc. side shutter, shelves etc. complete with locks, clip catcher as per the plan made up with 18, 12, 10 mm th. ply board of approved make and quality with 1.0 mm thick laminate as given in tender specification fixed on the top and exposed face. Inside face shall be pasted with 0.7 mm off white liner mica/putty, painted in white paint. 1) DM room table - (6'x3'x2'6")	1	nos		
6	Providing, fabricating and fixing in position counter table of size 4'6" x 2'3" x 2'6" with drawers etc. shelves etc complete with locks, clip catchers handle as per the plan made with 18, 12, 10 mm th ply board of approved make and quality with 1.0 mm thick laminate as given in tender specification fixed on exposed faces. All inside faces to be pasted with 0.7 mm off white liner mica/ putty, painted with white paint. (Work stations)	12	nos		
7	Providing, fabricating and fixing in position in Agent's Circular table of size 3'0"x 2'6" as per drawing made of as per the plan made with 18, 12, 10 mm th ply board of approved make and quality with 1.0 mm thick laminate as given in tender specification fixed on exposed faces. All inside faces to be pasted with 0.7 mm off white liner mica/ putty, painted with white paint.	2	nos		
8	Providing, fabricating and fixing in position in Off/Admin room table of size 4'6" x 2'6" x 2'6" with drawers etc. shelves etc complete with locks, clip catchers handle				

	as per the plan made with 18, 12, 10 mm th ply board of approved make and quality with 1.0 mm thick laminate as given in tender specification fixed on exposed faces. All inside faces to be pasted with 0.7 mm off white liner mica/ putty, painted with white paint.	10	nos		
9	Providing and fixing of table at the reception with the specification as in item No. 6.	1	nos		
10	Providing, fabricating and supplying and fixing in position service counter as per the plan made with 18 mm, 12 mm, and 6 mm ply of approved make and quality with a counter top of 2'6" width at a height of 2'6" from the floor, with a length as directed/required complete. All exposed surfaces to be fixed with 1.0 mm thick laminate and inside faces like drawers, table, side table inside and back face shall be pasted with 0.7mm off white liner mica. The back side of the cabinet, side tables wherever visible shall have mica same as that of the color scheme with all necessary handles, locks, night latch, hinges, keyboard tray etc complete.  1. Computer working counter 2. Cash counter	15 5	rft rft		
11	Providing and supplying vertical blinds for windows in colour/design as directed. Make: Marvel, Vista, Mac	220	sft		
12	Providing and fixing standing free suggestion box made of plyboard 12mm thick 450mm long x 300mm deep x 900 mm high. The box shall have openable shutter with all necessary fixtures.	1	nos		
13	Providing and fixing notice board in ply board of 6mm fixed on a frame of 50mmx25mm well seasoned wood polished and top fixed with bead. 12mm thick soft board clad with fabric of matching colour and shade complete with all fixtures necessary as required.	20	sft		
14	File cabinet in CRM RM Mg hall of size/design as per the drawing made of 18, 12 mm plyboard with all the necessary fixtures like handles, lock, clip catcher etc. all the exposed surface are to be pasted with mica 1.2 mm th as per color scheme whereas inside and the back side shall be pasted with 0.7 mm off white mica. The back side of cabinets wherever visible shall have the same mica as that of the color scheme. 1. File rack of size (1'6" x 3/4') high placed on floor. 2. Credenza (side table) for tables.	530 180	sft sft		
15	Providing & pasting frosted film (3M, Garware make)				

	on glass work including bank logo as required as directed by the consultant/Architect.	130	sft		
16	Fabricating and fixing in position lunch tables of size as required to seat 4~6 person complete with open space at the centre made of ply board of appropriate make and quality with 1.0 mm th. laminate of colour and make as given in the tender specification fixed on all exposed faces. Inside faces to be pasted with 0.7 mm off white liner mica (In training hall/conference).	1	nos		
	TOTAL			Rs.	

## 2. FALSE CEILING WORKS

S.No.	Item/Description	Qty	Unit	Rate Rs.	Amount Rs.
1	Providing and fixing false ceiling as per approved plan with Gypsum board (India Gypsum, Lafarge) 12 mm th on frame consisting of main and cross runners of GI section of 2.5" size @ 2.85 kg/12 feet and 1.75" @ 2.9 Kg/12 feet connected with screws to form a grid of not more than 2'x2'. Opening for lights and fans to be provided. The ceiling height shall not be less than 9'6" from the floor. The rate includes all extra frame work required to hold the concealed light fixtures, jointing with compound and fibre tape 3mm gypsum punning/ plastering and 3 coats of Asian/Nerolac Acrylic emulsion paint.	2800	sft		
	TOTAL			Rs.	

## 3. PAINTING WORKS

S.No.	Item/Description	Qty	Unit	Rate Rs.	Amount Rs.
1	Inside painting in two coats with plastic paint of approved quality, make (Nerolac, ICI, Asian or equivalent), color and shade including ceiling and cornices in two or more coats. The cost includes one coat of cement primer and putty on the surface made ready after surface preparation viz. rubbing, cleaning and repairing of cracks etc. complete.	3850	sft		
2	Painting with synthetic enamel / oil paint of approved brand (Nerolac, ICI, Asian) and manufacture to give an even shade in two or more coats as required/directed.				



	the cost includes making the surface smooth with oil based putty, red oxide paint in one coat in case of iron steel grill etc complete after surface preparation rubbing cleaning complete. Door, Window, grills, CG, shutters.	650	sft		
3	Water proofing of concrete surface/ slab, lintel etc with 3 coats of water proofing layers viz. first coat of primer, two coats of water proofing gelly (EMB) topping it with two coats of aqua guard mixed with cement slurry. The rate is inclusive of cleaning of the surface with a wire brush, removing the dust with air, filling of crack with polymeric putty and as required as per site condition.	400	sft		
	TOTAL			Rs.	

#### 4. ELECTRICALWORKS

S.No.	Item/Description	Qty	Unit	Rate Rs.	Amount Rs.
1	Providing and fixing, testing and commissioning for point wiring two nos. 1.55 sq. mm/2.5 sq.mm or 4.0 sq. mm PVC insulated single core stranded copper conductor wire 1100 volt grade (for Ph&N) and one nos. 1.0 sq. mm/ 1.5 sq. mm PVC insulated single core stranded copper conductor wire 440 volt grade, for earth wire 1.6 mm th. 25 mm dia BEC / NIC / AKG make PVC conduit pipes. All wires are to be ISI mark approved / specified make Anchor/ Finolex / Havells complete with all drops up to boards, staples, accessories and hardware etc. Installing the conduit in slabs, wall etc. The point shall include modular type switches of MK Anchor, Roma, Crab tree make as approved / specified in required combination including electronic regulator , 6 ASP control switch 3-plate ceiling rose, angle or straight holder adequate size to mount control switches for lights, fan sockets. Sockets for half points and ceiling fan regulator.				
	a) Light points.	75	nos		
	b) Fan with regulator (ceiling + bracket) exhaust fan points (2x1.50 sq.mm + 1x1.5 sq.mm)	20	nos		
	c) Call bell points inclusive of call bell.	1	nos		
	d) 6 Amp 3/5 pin point (half point) (2x1.5 sq.mm + 1x 1.5 sq.mm)	6	nos		
	e) 16 Amp 3/5 pin point (2x2.5 sq.mm +1x1.5 sqmm)	6	nos		

	f) On/Off switch 25 A starter for modular Havell's make.	9	nos		
2	Supplying, fixing and testing of telephone socket point wiring with two line telephone wire of approved Anchor Havells/Finolex make in 1.6 mm th 1" dia PVC conduit pipe including double line tel-Jack (modular type) on the switch board.	10	nos		
3	Supplying ,erecting and testing of approved/specified make Crompton, Havel, Usha electric ceiling fans complete with down rod, canopy, blades and speed regulator 230-250 volts including connection with all necessary materials as required.	20	nos		
4	Supplying, erecting and testing of approved / specified Havels, Orient or Crompton make oscillating cabin fan complete with base, blades, gaurds, speed regulators etc. 230-250 volts with connections, raw bolts/anchor hole fastener completely finished as required.	3	nos		
5	Supplying, erecting and testing of approved / specified GEC Crompton make Trasnair (900 rpm) compete with motor, mounting, frame, blades with connection, bolts, anchor fasteners etc complete as required.	3	nos		
6	Supplying, fixing and testing of approved Wipro/Havells Crompton, Cisca, Halonix LED fittings  1. Recessed mounting 2'x2' LED fittings Wipro : Crompton : Equivalent make of Wipro, Havells, Crompton  2. Recessed mounting 12 w LED Down light. down lighters of Wipro, Fortune Art make.  3. Supply and installation of strip light fitting of Crompton/Wipro/Havells make (1x28 W FTL T5)  4. Recessed mounting 1'x2' LED fittings Wipro : Crompton : Equivalent make of Wipro, Havells, Fortune Art	32	nos		
		24	nos		
		14	nos		
		4	nos		
7	Supply and installation of circuit in app. make 1.6 mm thick, 25mm dia PVC pipes and at places where decorum is to be maintained in PVC casings with approved make PVC insulated wire as under. The rate shall be inclusive of all necessary fittings like junction boxes, tees, bends, saddles screws etc complete. PVC pipe to be of BEC/NIC/AKG make and wire of Havells, Anchor				

	Finolex make. a) 4x2.5 sq.mm + 2x1.5 sq. mm b) 2x2.5 sq. mm + 1x1.5 sq. mm c) 2x4 sq.mm + 1x2.5 sq.mm	140 120 100	mts mts mts		
8	Supplying and installation of 1x6 sq.mm specified / approved make flexible copper PVC insulated earthing wire through 20 mm dia B class G.I. pipe buried not less than 2' below ground level. The wire shall be without joint except connection with bolted link. The rate shall include for all earthing connections on the main panel with the earth station by means of brass nuts and bolts using socket terminals. PVC conduit to be of BEC, NIC, AKG make.	30	mts		
9	Providing, fixing, testing and commissioning copper earth plate 2x 600x600x 3mm including accessories and providing enclosure in CM, cover plate having locking arrangement and watering pipe 20mm GI "B" class etc with salt, charcoal, earthing electrode complete.	1	nos		
10	Supply and installation and connection of modular type app./ specified switch and socket complete with PVC box plate screws and all other accessories. a) 2 Nos. socket + 2 Nos. switches (6A) b) 1 Nos. socket + 1 Nos. switch (6/16A)	26 26	nos nos		
11	Supply, installation, testing and commissioning of the following items on the main panel, made of MS angle frame of 25x25x3 mm. The frame should be fixed on the wall with cement mortar firmly and be painted with two coats of oil paint. 1) 100 amps cut outs 3 nos. on the panel. 2) Main switch with HRC fuses, 125 amps. Crompton Greaves or Havel's make. 3) MCB DB having incomer 1 nos. 100 amps TPN Isolator and 2 nos. 32 amps TPN MCB outgoing. (Havel's/MDS make factory fabricated). 4) TPN MCB 63 amps, 415 V with enclosure (Havells/ MDS make) 5) MCB DB having incomer 1 nos. 100A DPMCB and 16 nos. 6/32 A.S.P. MCB (Havells/MDS make factory	3 1 2 1	nos nos nos nos		

	fabricated)	2	nos		
	6) 100 amps change over switch of Havell's make	1	nos		
	7) 3 phase indicator lamp with gang box.	1	nos		
12	Supply and installation of 4Cx10 sq. mm aluminum armoured cable with accessories required for connecting the DB with the main panel board. Cable should be of CCI/GLOSTER/FINOLEX make.	15	mtr		
13	Supply and installation of 3.5Cx70 sq.mm Aluminium armoured cable with accessories required for its fitting in position, for power supply from CSEB pole and DG set. Cable should be of CCI/GLOSTER/FINOLEX make	15	mtr		
14	Data cabling works				
	a) Providing supplying and laying of new D-Link concealed/open data line Cat 6e in separate ISI pvc casing capping (as and where required) for the location of computer terminals, inclusive of fixing of jack socket of link or equivalent make including testing, commissioning, certification etc. complete.	1090	mtr		
	b) Supplying and installation of jack type computer socket Link make RJ-45, complete with female unit on counters/side table/ walls along with other electrical output.	24	nos		
	c) Providing and fixing				
	i) D-link 24 Port Patch Panel	1	nos		
	ii) 48 Port Switch of D-link make	1	nos		
	ii) D-link Patch cord cat6 2 metre B/Y Color	20	nos		
	iii) D-link Patch cord cat6 1 metre B/Y Color	20	nos		
	TOTAL			Rs.	

TOTAL (1+2+3+4)

Rs.

(In words .....)

Date:

Seal & Signature of Contractor

Place:

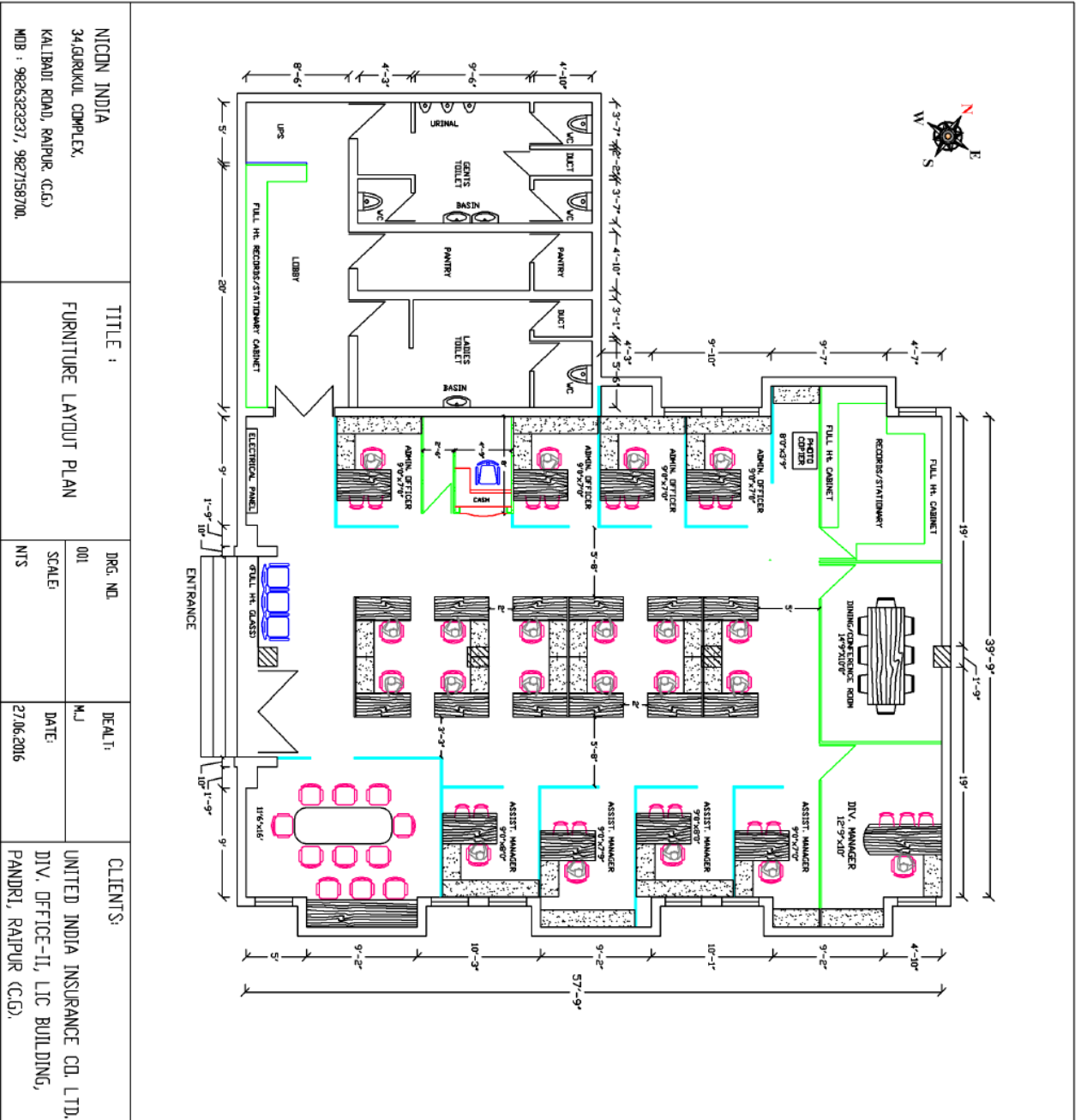

NJCCON INDIA 34,GURKUL COMPLEX, KALIBADI ROAD, RAIPUR (C.G.) MDB : 9826323237, 9827158700.		<b>TITLE :</b> FURNITURE LAYOUT PLAN		<b>CLIENTS:</b> UNITED INDIA INSURANCE CO. LTD. DIV. OFFICE-II, LIC BUILDING, PANDRI, RAIPUR (C.G.)	
DRG. NO.	001	DEALT:	M.J	DRG. NO.	001
SCALE:	NTS	DATE:	27.06.2016	SCALE:	NTS

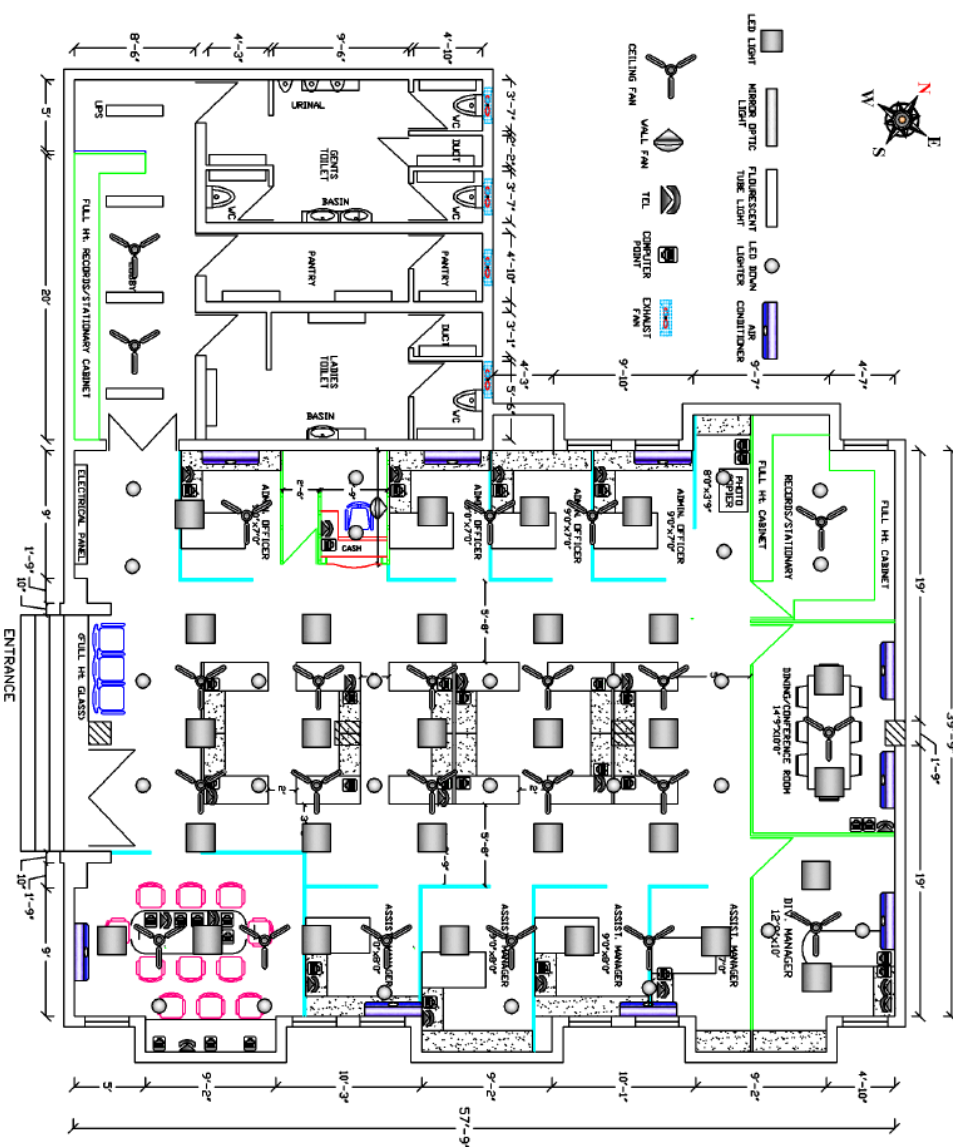

NICON INDIA 34, GURUKUL COMPLEX, KALIBADI ROAD, RAIPUR. (C.G.) MOB : 9826323237, 9827158700.		<b>TITLE :</b> ELECTRICAL LAYOUT PLAN	
<b>DRG. NO.</b> 001	<b>DEALT:</b> M.J	<b>SCALE:</b> NTS	<b>DATE:</b> 27.06.2016
<b>CLIENTS:</b> UNITED INDIA INSURANCE CO. LTD, DIV. OFFICE-II, LIC BUILDING, PANDRI, RAIPUR (C.G).			